

LENOX[®] LOCKERS

Practical. Durable. Preferred.



Standard Lockers
Gear Lockers
Z-Lockers
Cubby Lockers

Bench Lockers
Cubby Bench Lockers
Pedestal Benches

Commercial Washrooms. Brought to Life.





Lenox Lockers

With exclusive, patented features you can't find anywhere else, Lenox Lockers are the preferred specification for locker rooms.

Lenox Locker Advantage

- 1 Most secure locking/latch system available: patented continuous slide latch made of $\frac{1}{2}$ " (127mm) thick High-Density Polyethylene (HDPE) secures the entire length of the door
- 2 Patented integral box provides strength: top and bottom are welded to frame; door and frame assembly is welded to box
- 3 Optional slope top helps prevent items being stacked on top
- 4 Heavy-duty stainless steel piano hinge is more durable and longer lasting than aluminum or plastic
- 5 Ergonomic handle makes it easy to open the full length latch and conceals a metal hasp for pad locks
- 6 Multiple locking mechanism options
- 7 Ships fully assembled and ready for a fast and easy installation
- 8 Made from 30% pre-consumer content, 100% pre-consumer content or 100% post-consumer content

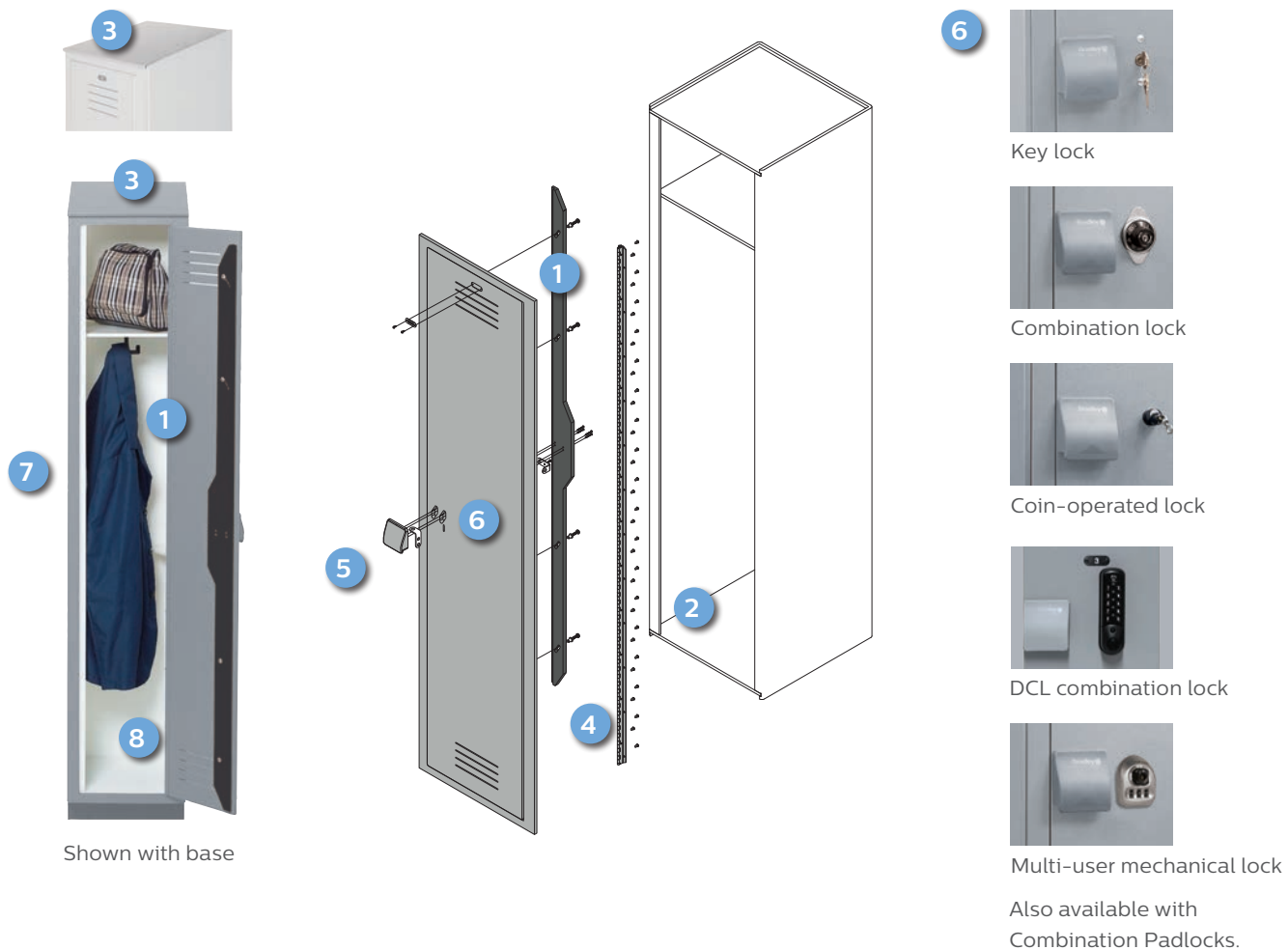



Standard Locker

A wide range of sizes, tiers, colors, and options

- 1–6 tier options available
- Height: 24", 36", 48", 60", or 72" (609mm, 914mm, 1219mm, 1524mm, or 1829mm) *6-tier: 72" (1829mm) height only
- Width Options: 12", 15", or 18" (305mm, 381mm, or 457mm)
- Depth Options: 12", 15", or 18" (305mm, 381mm, or 457mm)
- XL Depth Options: 21" or 24" (533mm or 609mm)

Z-Locker

Lenox Z-Lockers provide practical multi-level storage without wasted floor space

- Only available in 2 tier
- Height: 60" or 72" (1524mm or 1829mm)
- Width Options: 15" or 18" (381mm or 457mm)
- Depth Options: 12", 15", or 18" (305mm, 381mm, or 457mm)
- XL Depth Options: 21" or 24" (533mm or 609mm)



Gear Locker

With extra width & depth these lockers have plenty of secure storage space to accommodate all types of bulky equipment and gear. Ships fully assembled for quick, easy installation. 'Soft-Down Stay' slow close hinge on storage bin — no slamming or pinched fingers. Perfect for fire and police departments, locker rooms, recreation and fitness facilities

- Height: 72" (1829mm)
- Width Options: 24", 30", or 36" (609mm, 762mm, or 914mm)
- Depth Options: 18", 21", or 24" (457mm, 533mm, or 610mm)



Cubby Locker

Easy-access, durable cubby lockers are perfect for items that do not require locked storage.

(Three cubby lockers pictured.)



Cubby Bench

Convenient seating and easy-access storage.



Locker Bench

Convenient seating and storage with hasp lock.



Pedestal Bench

Locker room benches complete the long line of solid plastic products for your restroom and locker room applications.

Made-to-Order Options

- Flat tops
- Slope tops
- Mesh doors
- Plastic coat hooks
- Metal wall hooks
- Coat rods
- Engraved logos
- Number plates
- Filler panels
- End panels
- Drain holes
- Bases
- Built-in key locks
- Built-in combination locks
- Coin-operated locks
- Digital combination locks
- Combination padlocks
- Multi-user mechanical Lock



Metal lockers don't stand a chance.

Quick installation and low maintenance costs add up to a 50% life cycle cost savings with Lenox Lockers.

Cost Savings with Lenox Lockers

Over time, metal lockers become dented and rusted like the tired looking example on the left. Maintaining 50 metal lockers for 20 years with four paint jobs and two door replacements per locker could cost \$31,000!

Plastic lockers may require additional investment up front, but significant savings on repairs and maintenance will make up the difference over Lenox Lockers' 20-year life cycle.

20-year Life Cycle	Metal Lockers	Lenox Lockers
Paint 4 times @ \$100* per locker	\$20,000	\$0
Replace doors 2 times @ \$110* per locker	\$11,000	\$0
Cost to maintain 50 Lockers	\$31,000	\$0

*Estimated cost



On average, each Lenox Locker in a post-consumer color keeps more than 500 milk jugs out of landfills, which equals: 242.5 kWh in Delivered Electricity Equivalent which equals 2,828.73 Thousand Btu in Net Energy Savings which equals

ENOUGH ENERGY SAVED TO RUN...



6.5 days



8 days



5.5 months



3 weeks



6.5 months

HDPE Solid Plastic

Unlike metal, Lenox Lockers are constructed from corrosion-proof, high-density polyethylene (HDPE) material that won't rust or dent.

- More resistant to scratches & easier to repair than metal
- 100% post-consumer HDPE recycled material available in three colors
- GREENGUARD GOLD certified as a low emitting material



Standard Colors



100% Post-Consumer

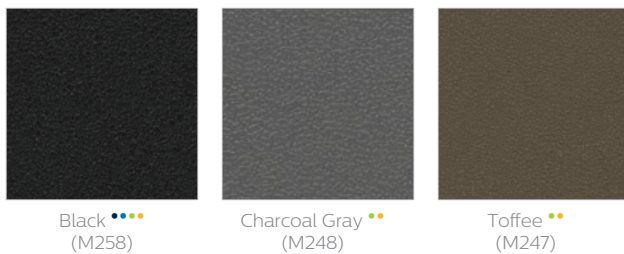

100% Pre-Consumer

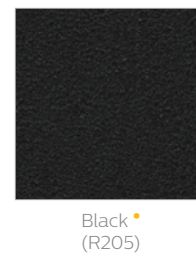

- Not available in Gear Locker
- Not available in Cubby Locker
- Not available in Locker Bench or Cubby Bench
- Not available in Pedestal Bench

20-Year Warranty

Never paint a locker again! You get maintenance-free lockers that still look new after years of use. Even spray paint and magic markers are easily removed with standard cleaning products. All plastic locker parts and components carry a 20-year warranty against rust, corrosion, denting and delaminating under normal use. Normal use definition: Lockers installed in a climate-controlled environment, away from direct sunlight.

U.S. Patents: 6,685,285; 6,792,661; 6,793,299; 7,029,078; 7,223,317; 7,278,695; 7,510,249; 7,699,412; 7,789,471; 8,113,602 Other patents pending



VISIT BRADLEYCORP.COM FOR INDUSTRY LEADING **BIM-REVIT/SYSQUE LIBRARY AND TECHNICAL DOCUMENTS**



Commercial Washrooms. Brought to Life.

HANDWASHING & DRYING | ACCESSORIES | PARTITIONS | LOCKERS

bradleycorp.com

800.BRADLEY | 262.251.6000
W142 N9101 Fountain Boulevard
Menomonee Falls, WI USA 53051

3787-0123